

# 3P Vibration POD assembly instructions

Andrew Dunn

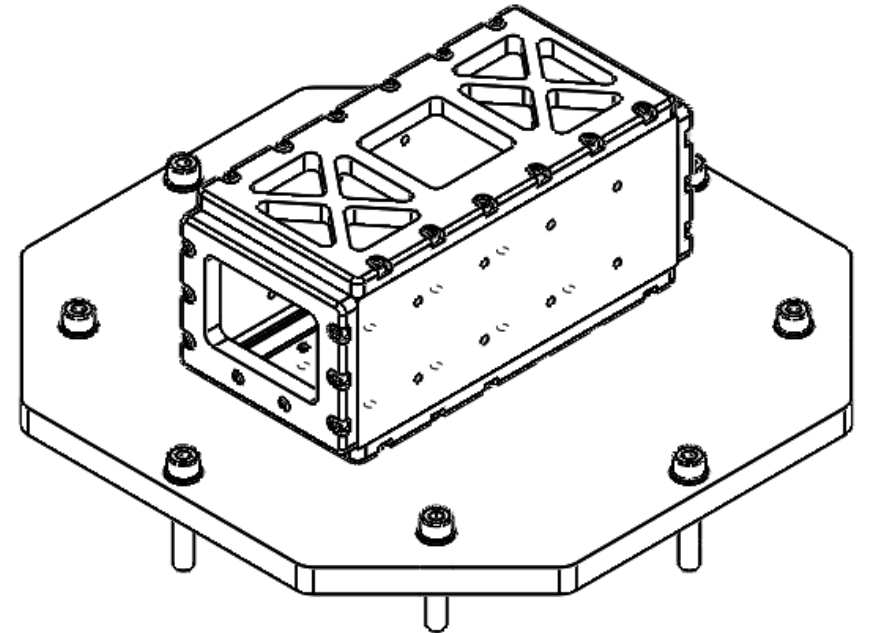

# Version

<b>Version</b>	<b>Date</b>	<b>Description</b>
V1	11/04/21	Document Created

# What you need

- LOCTITE 243 thread locker (apply to each screw)
- Torque wrench
- 2 x M6 Spring plunger (recommended from Misumi:**SPRZ6**)
- 46 x DIN912 M4 x 12mm bolts
- 8 x DIN912 M4 x 20mm bolts
- 8 x DIN125 M8 washers
- 8 x DIN912 M8 x 50mm bolts

# Parts list

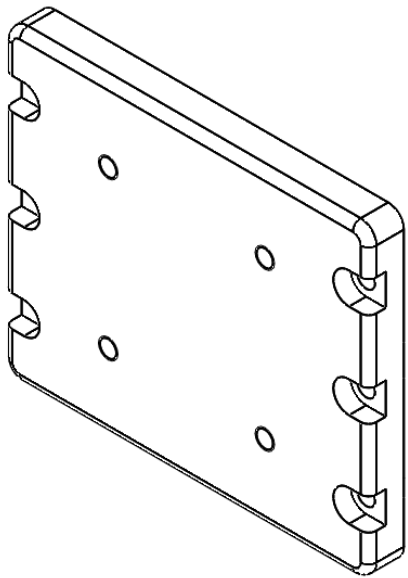

1x T065X004

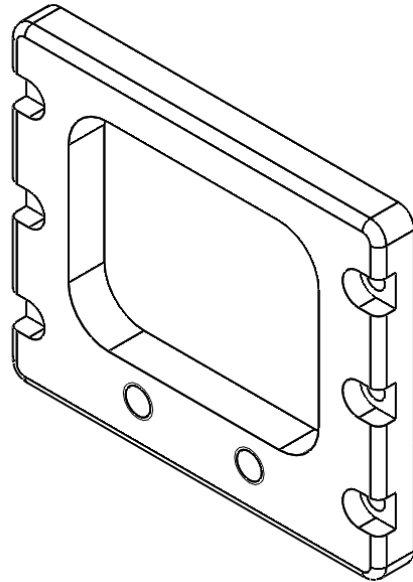

1x T065X006

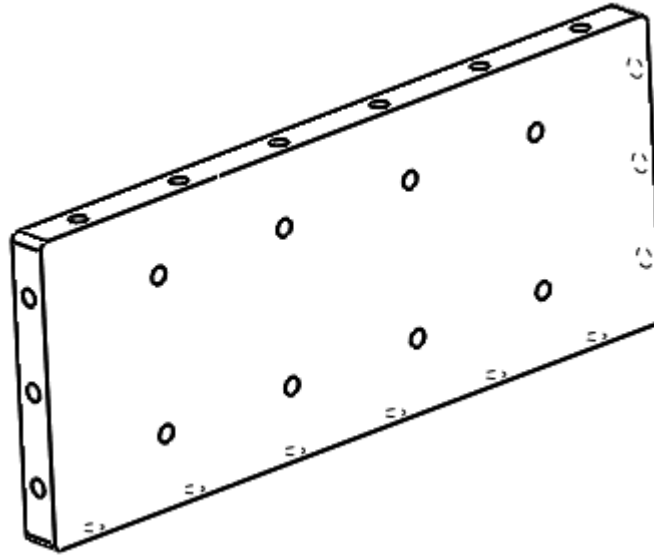

2x T064X002

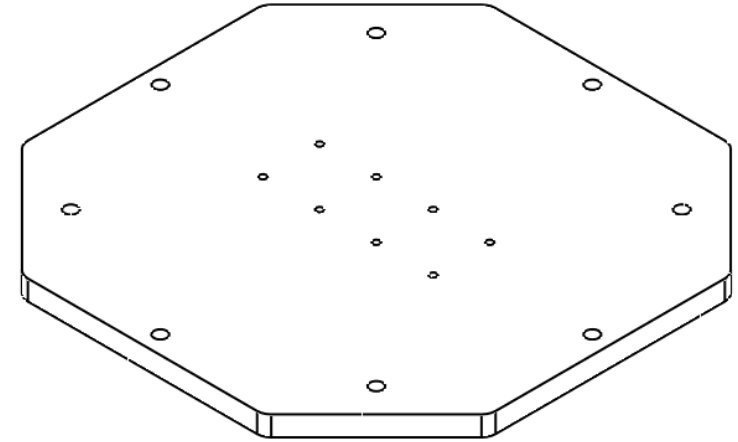

1x T064X001

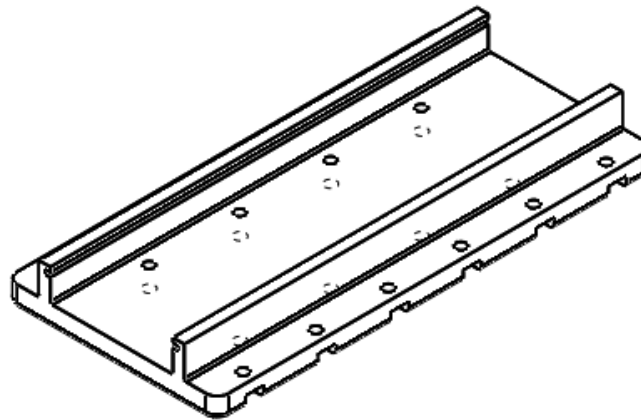

1x T064X003

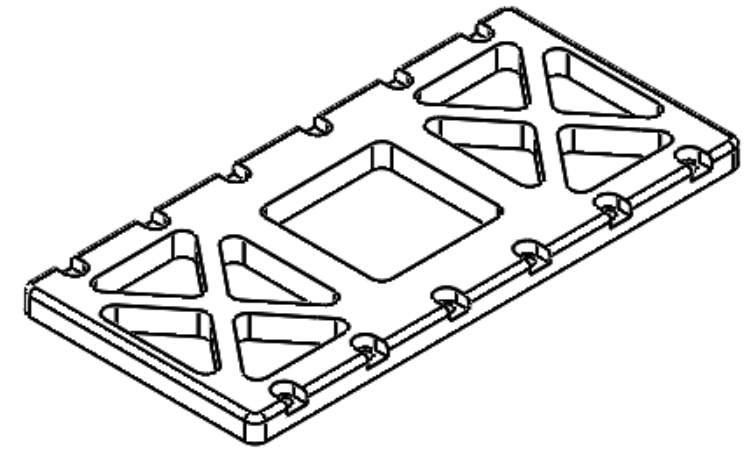

1x T064X005

STEP 1: Place both T064X002 onto T064X003

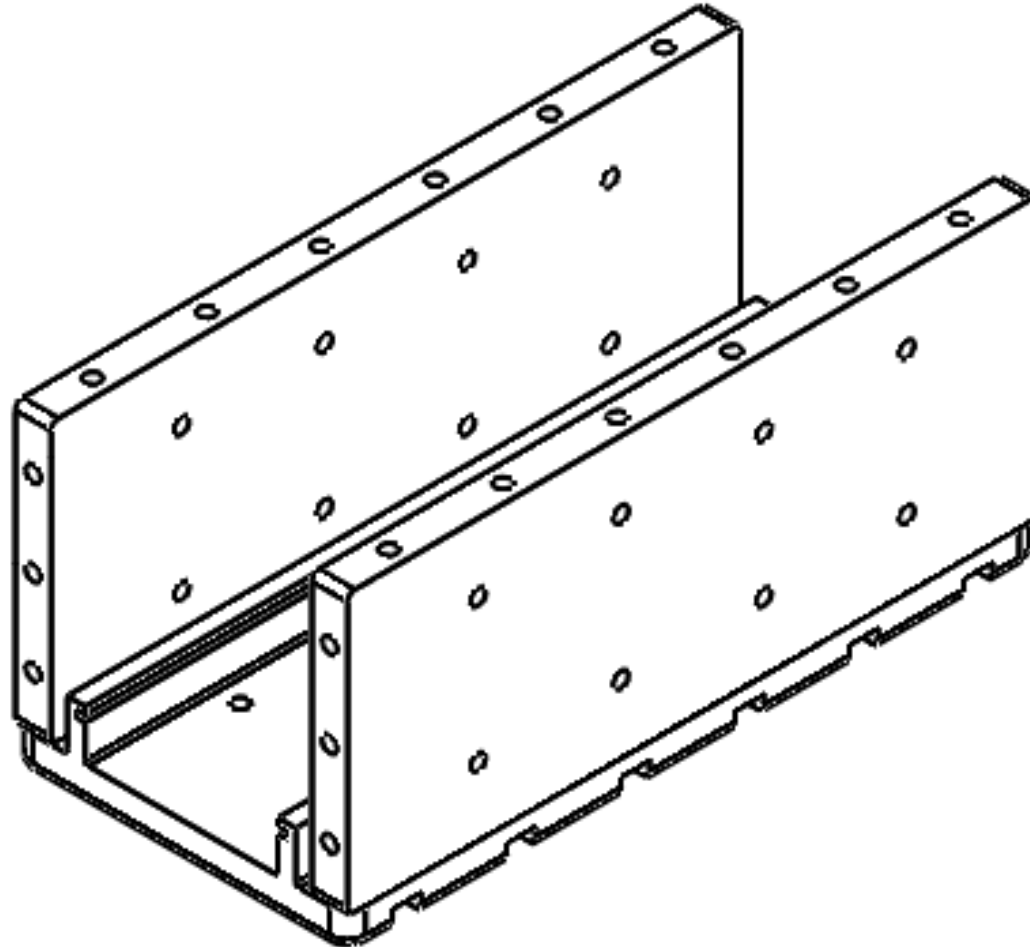

# STEP 2: Place M4 bolts into T064X003

- Insert and hand tighten torque each M4 x 12mm to the highlighted order.
- Once each screw is inserted tighten each screw to 4.8Nm.

Items needed:

- 12x DIN912 M4 x 12mm bolts.

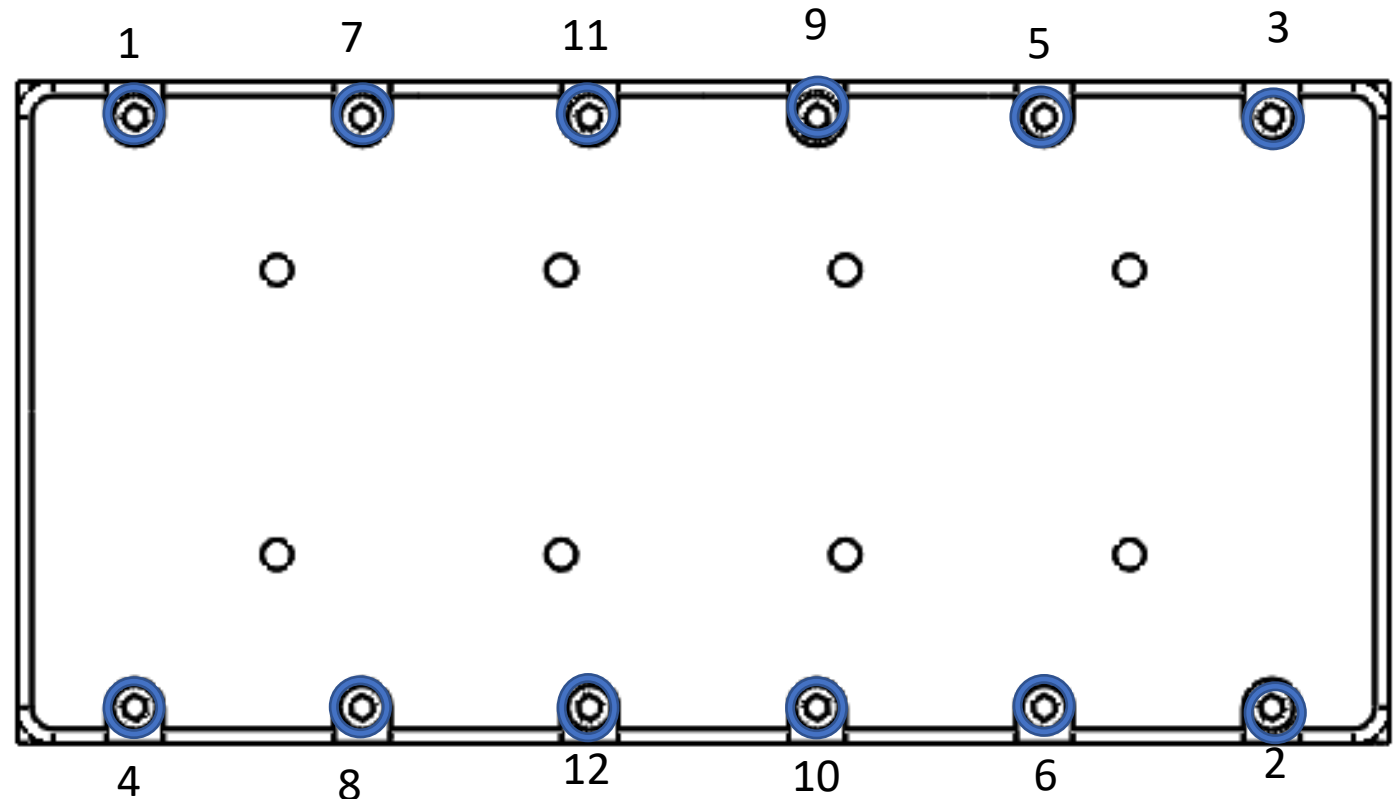

# STEP 3: Attach T065X004

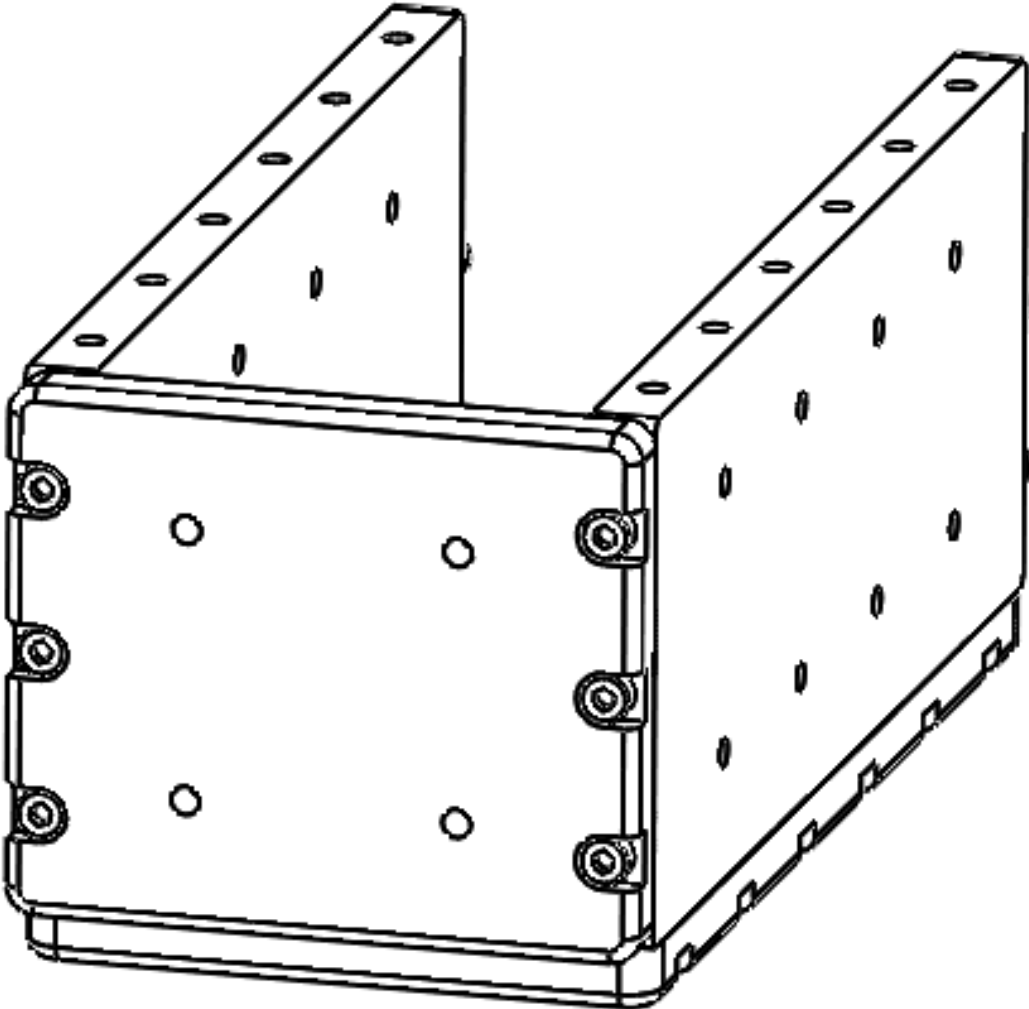

# STEP 4: Place M4 bolts into T065X004

- Insert and hand tighten torque each M4 x 12mm to the highlighted order.
- Once each screw is inserted tighten each screw to 4.8Nm.

Items needed:

- 6x DIN912 M4 x 12mm bolts.

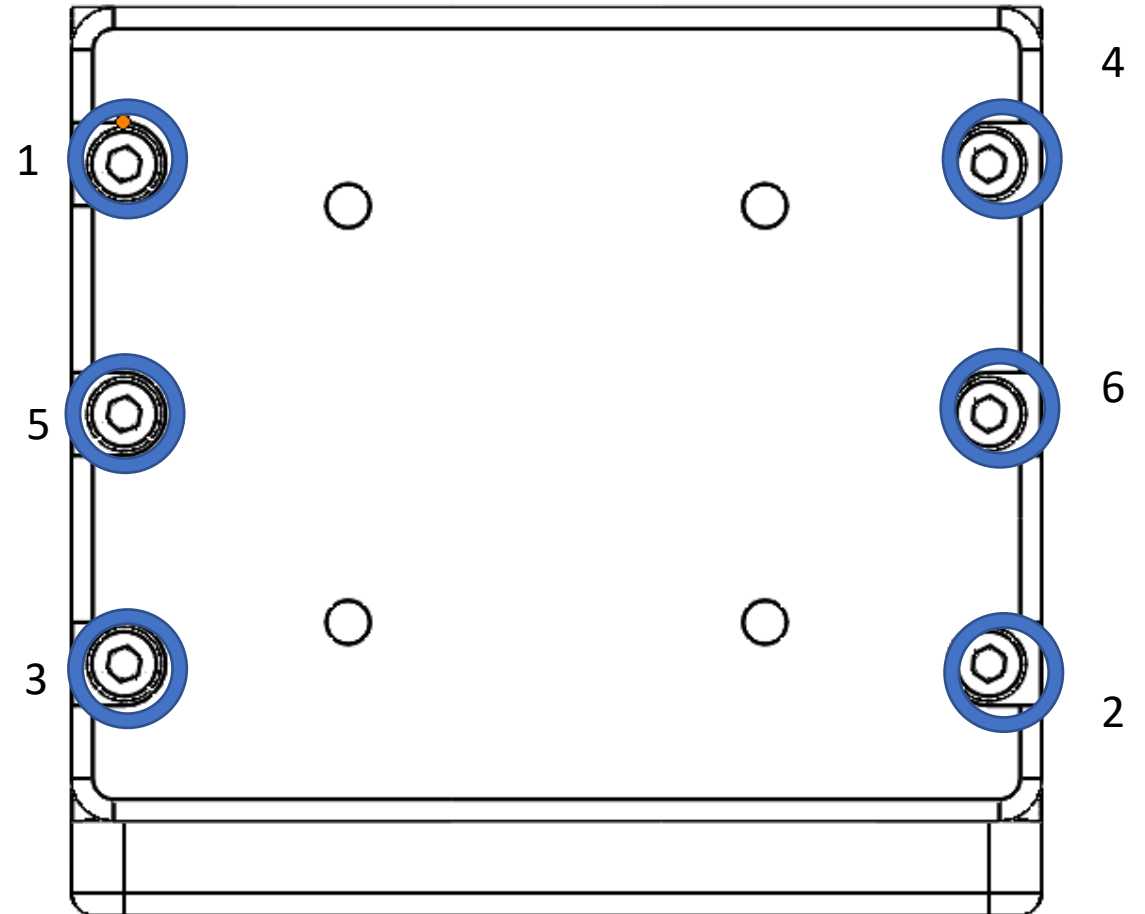



STEP 5: Attach T064X005

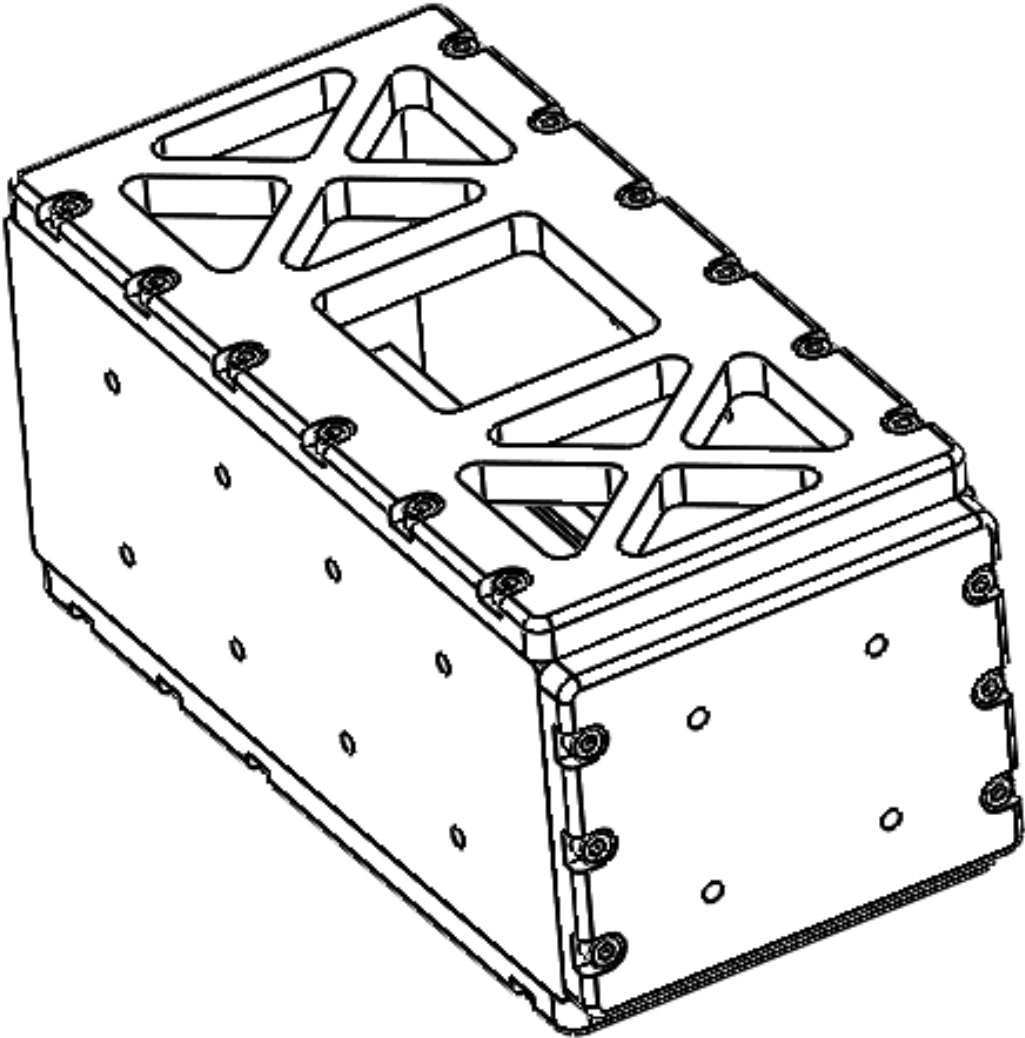

# STEP 6: Place M4 bolts into T064X005

- Insert and hand tighten torque each M4 x 12mm to the highlighted order.
- Once each screw is inserted tighten each screw to 4.8Nm.

Items needed:

- 12x DIN912 M4 x 12mm bolts.

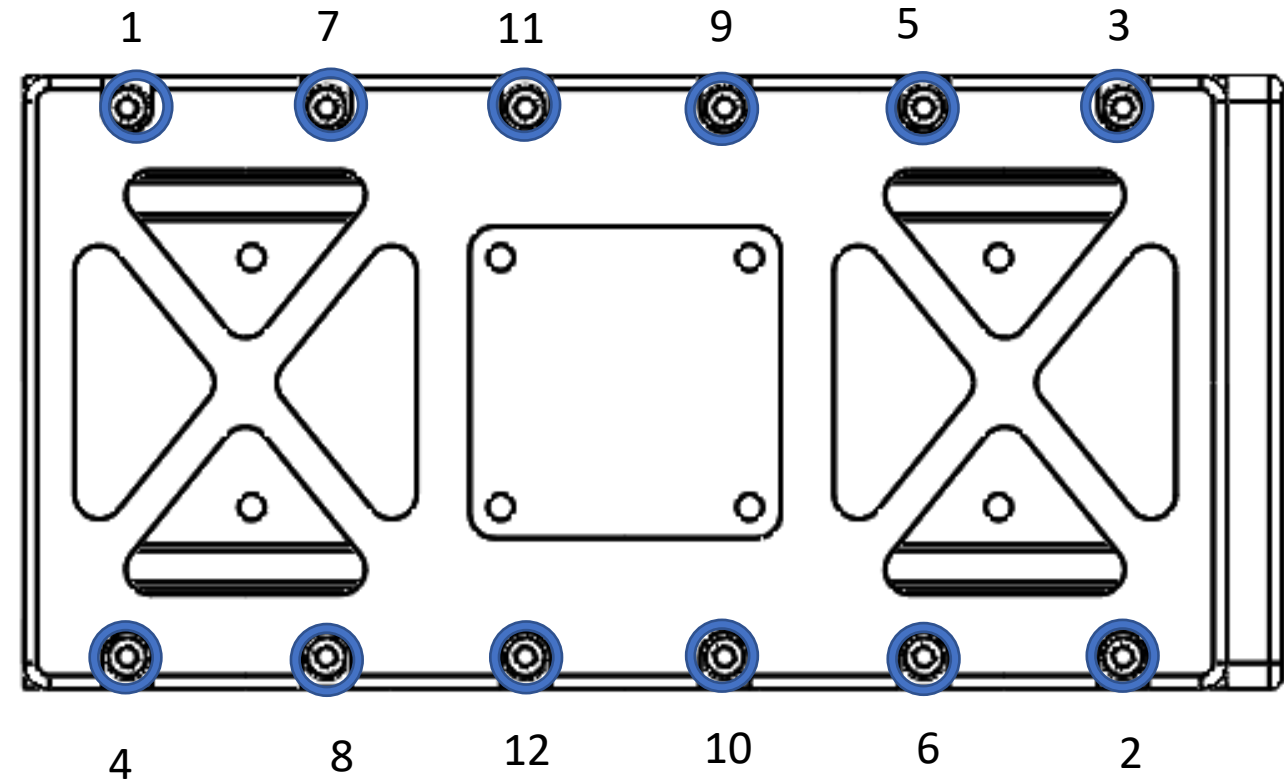

STEP 7: Insert 1 x 3P PQ into the POD

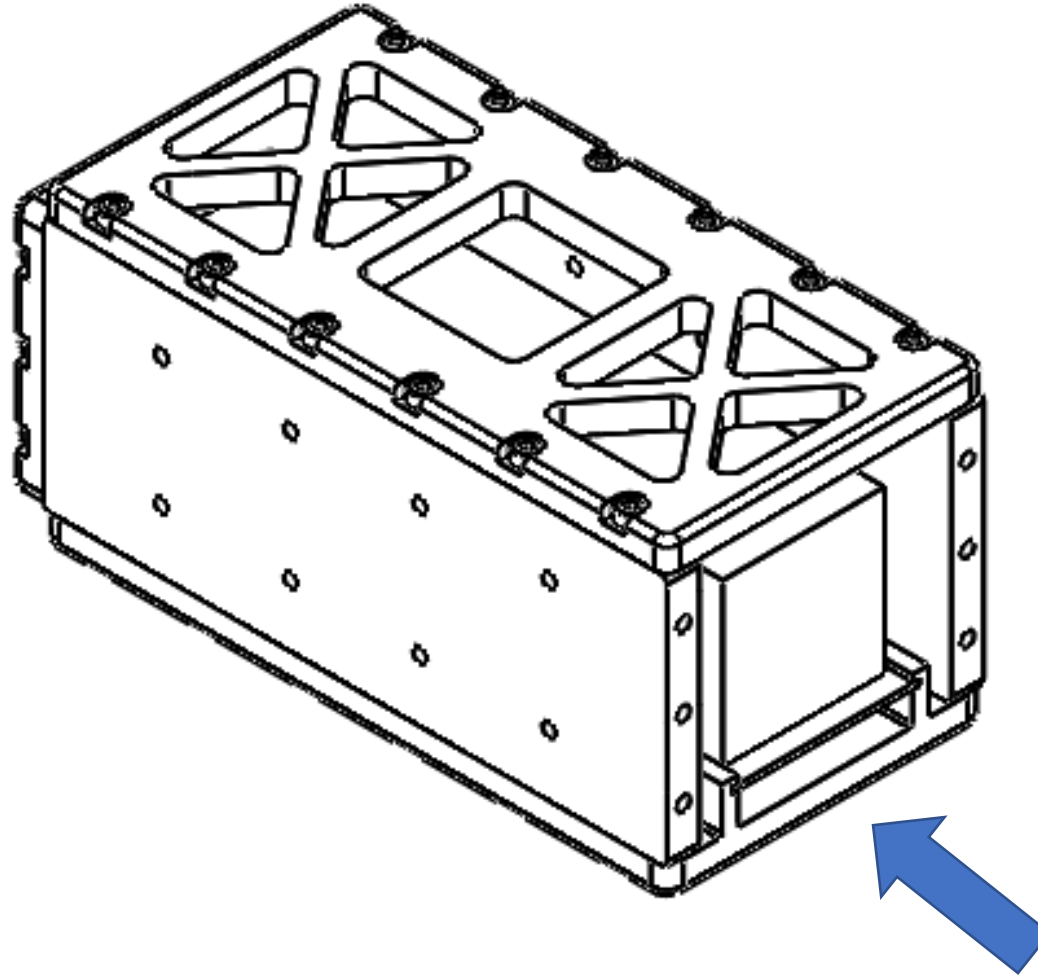

STEP 8: Attach T065X006

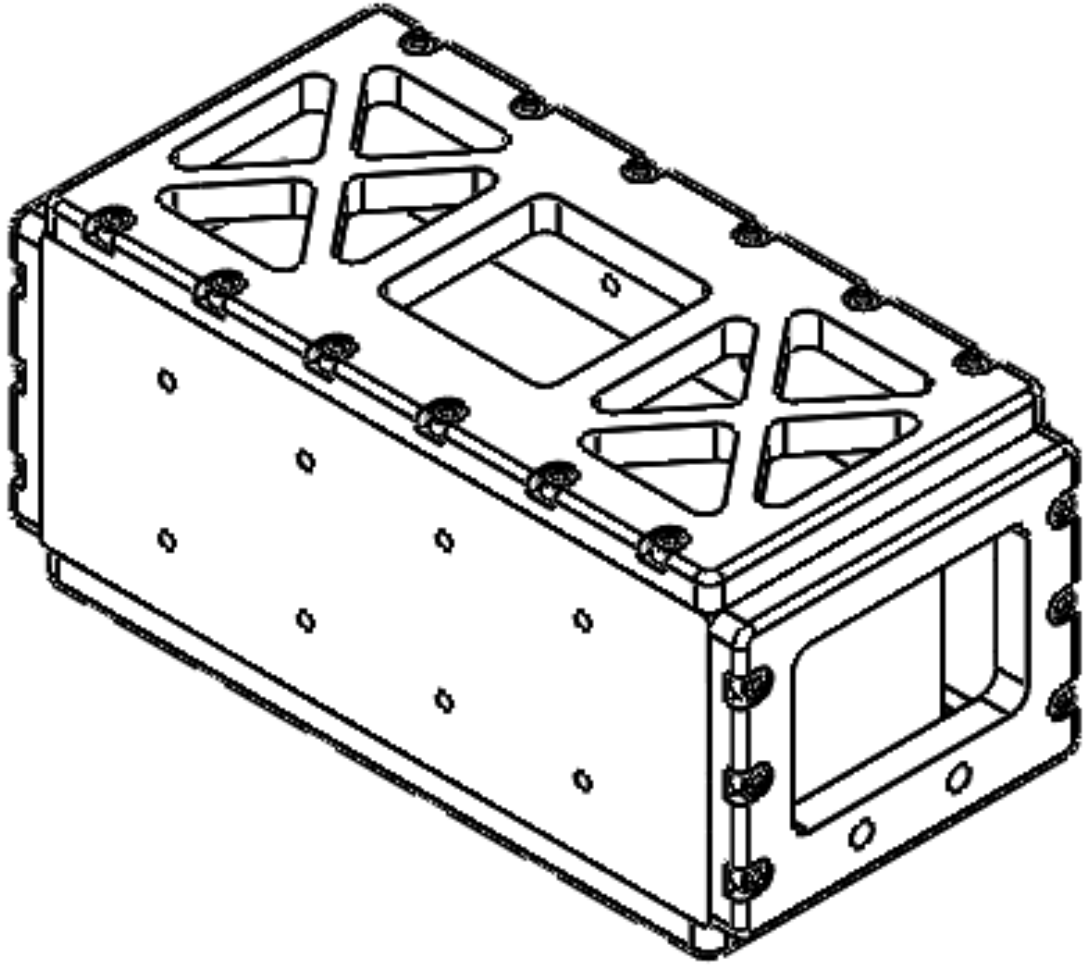

# STEP 9: Place M4 bolts into T065X006

- Insert and hand tighten torque each M4 x 12mm to the highlighted order.
- Once each screw is inserted tighten each screw to 4.8Nm.

Items needed:

- 6x DIN912 M4 x 10mm bolts.

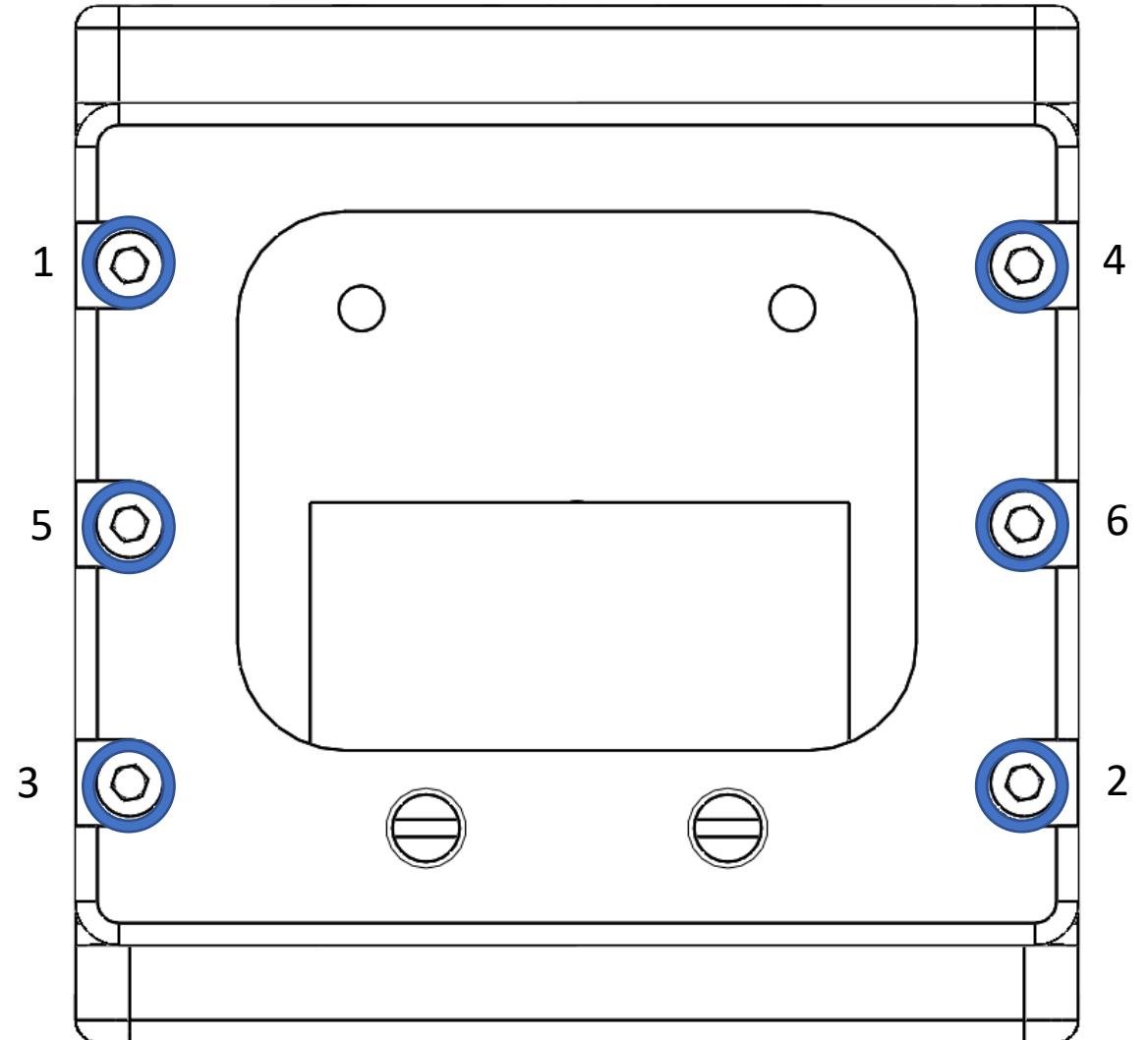

## STEP 10: Attach M6 Spring plunger to T065X006

- Insert M6 Spring plunger to T065X006.

Items needed:

- 2x M6 Spring plungers.

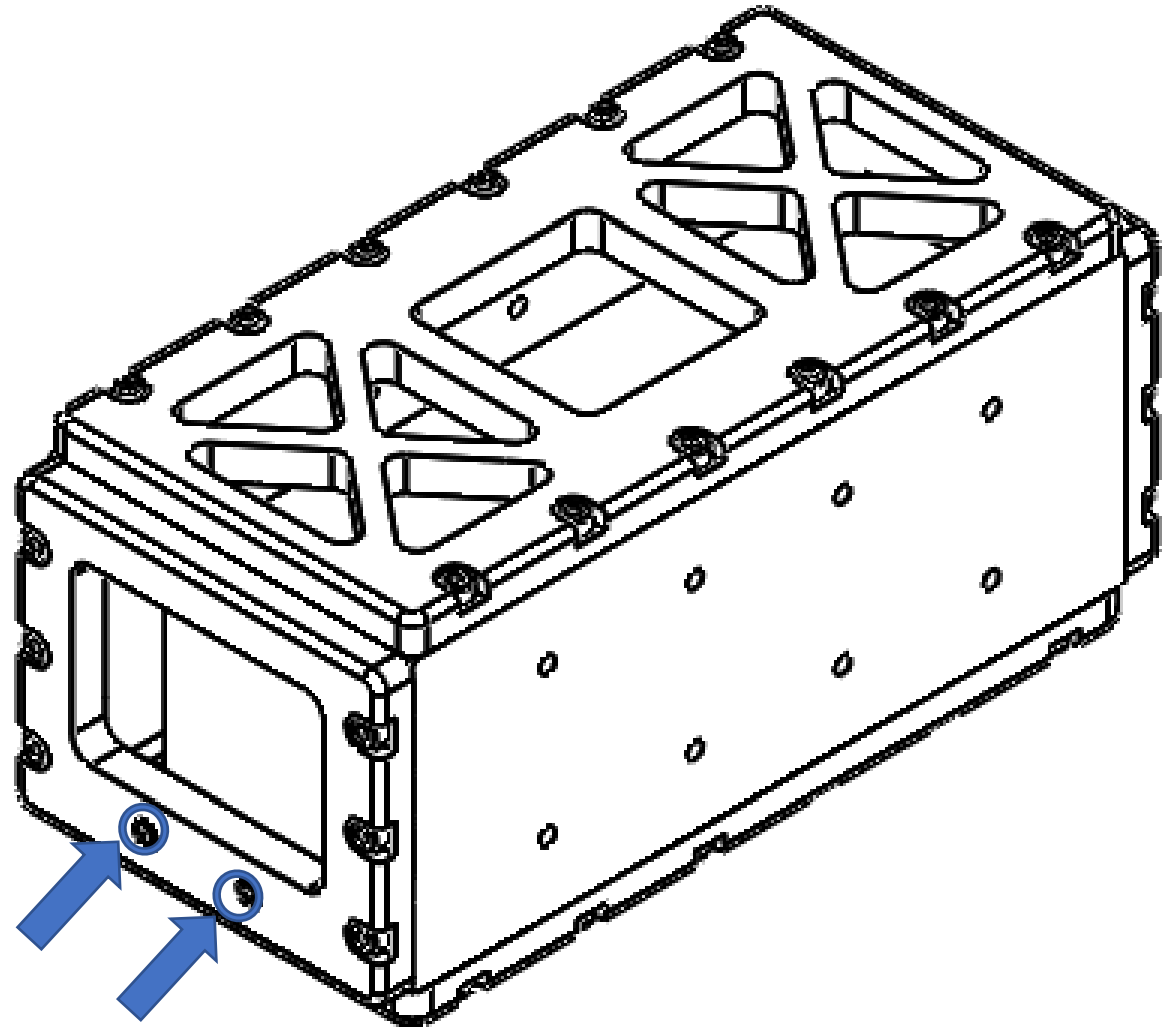

# STEP 11: Attach T064X001

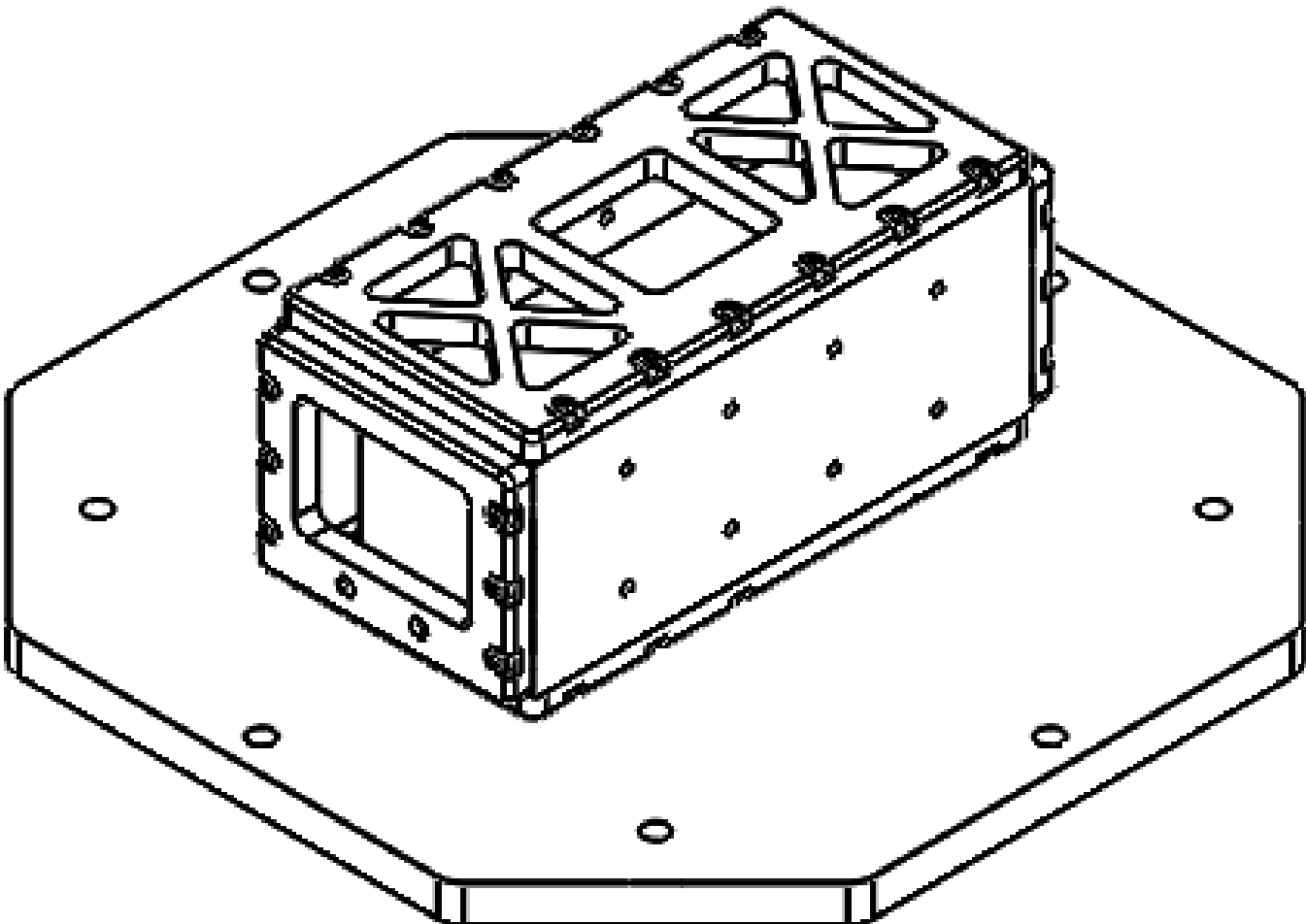

# STEP 12: Place M4 bolts into T064X001

- Insert and hand tighten torque each M4 x 20mm to the highlighted order.
- Once each screw is inserted tighten each screw to 7.0Nm.

Items needed:

- 8x DIN912 M4 x 20mm bolts.

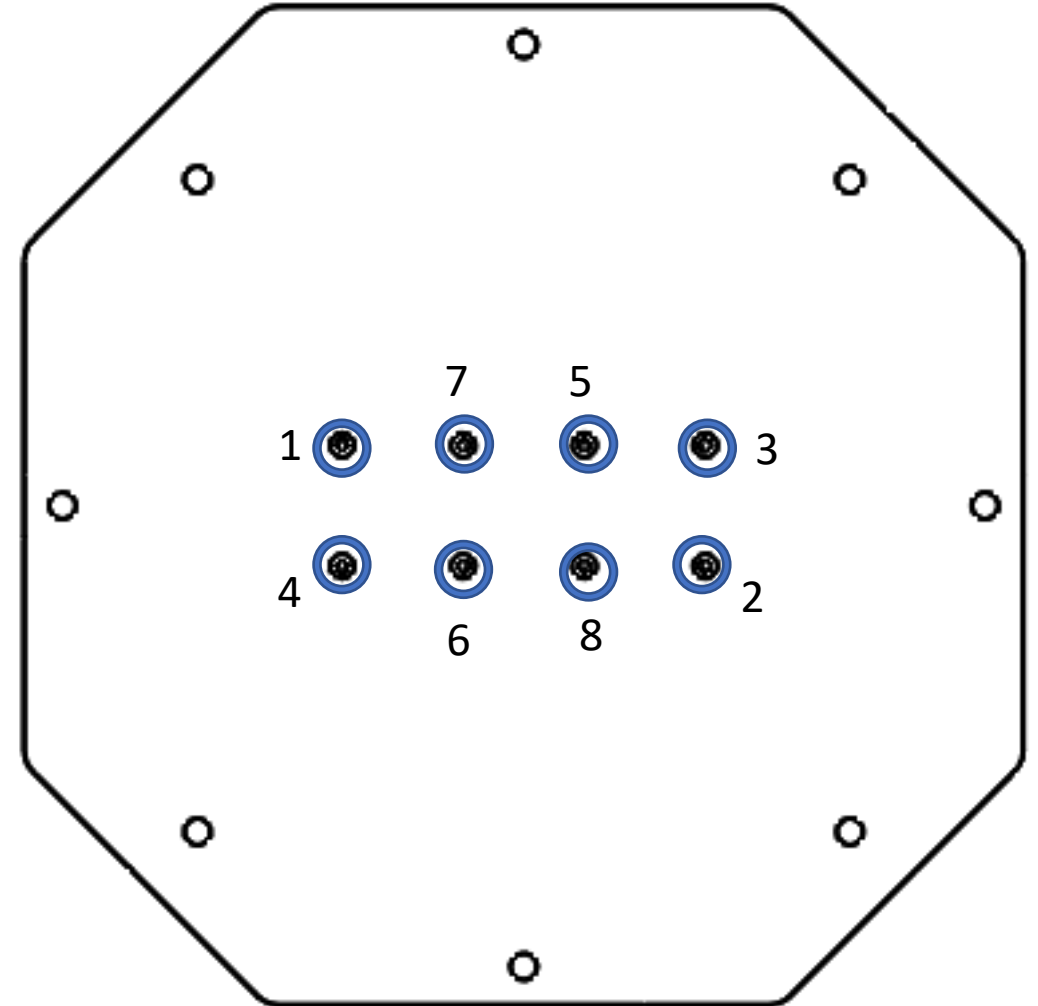



# STEP 13: Place M8 bolts into T064X001

- Secure the assembly to the vibrating table with M8 x 50mm bolts
- Once each screw is inserted tighten each screw to 31Nm.

Items needed:

- 8x DIN912 M8 x 50mm bolts.
- 8x DIN125 M8 Washers

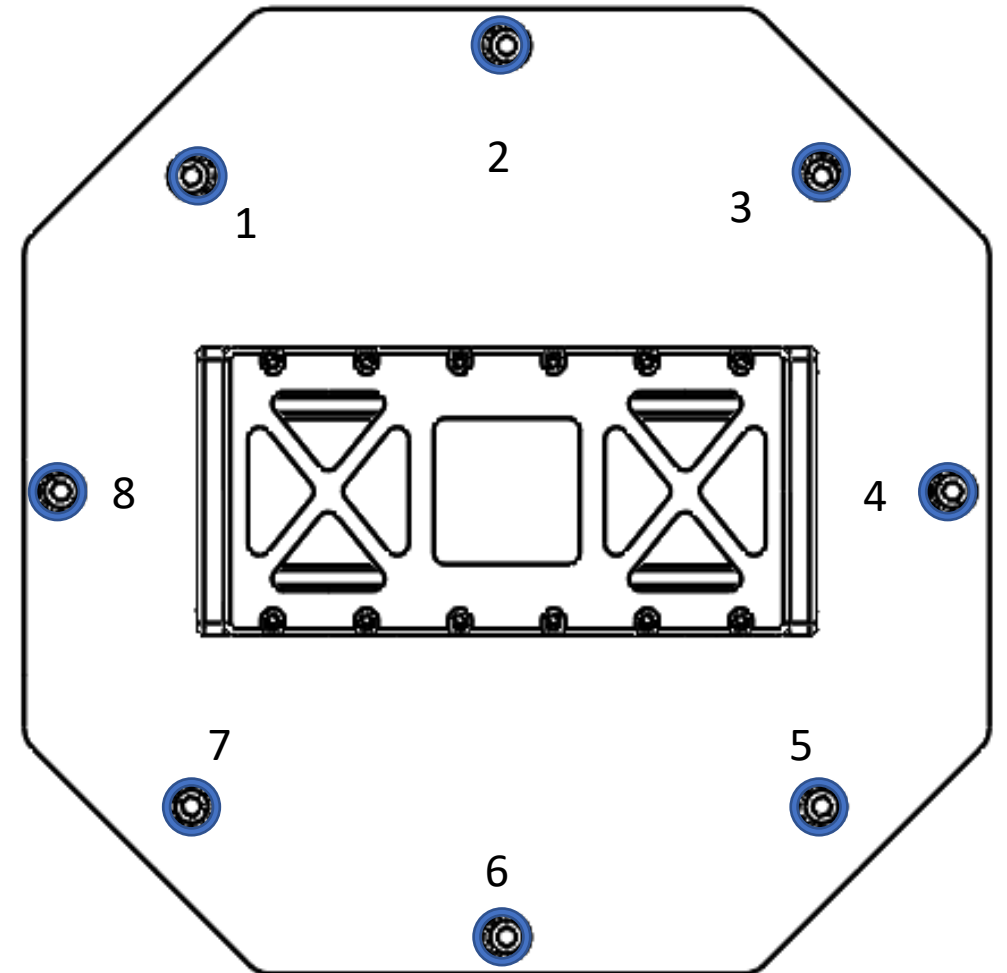

# STEP 14: Reorientation of VibePOD

- To test the VibePOD in another axis.
- Disconnect the adapter plate.
- Disconnect the VibePOD from the adapter plate.
- Flip the VibePOD to the new orientation.
- Follow Steps 11 – 13.

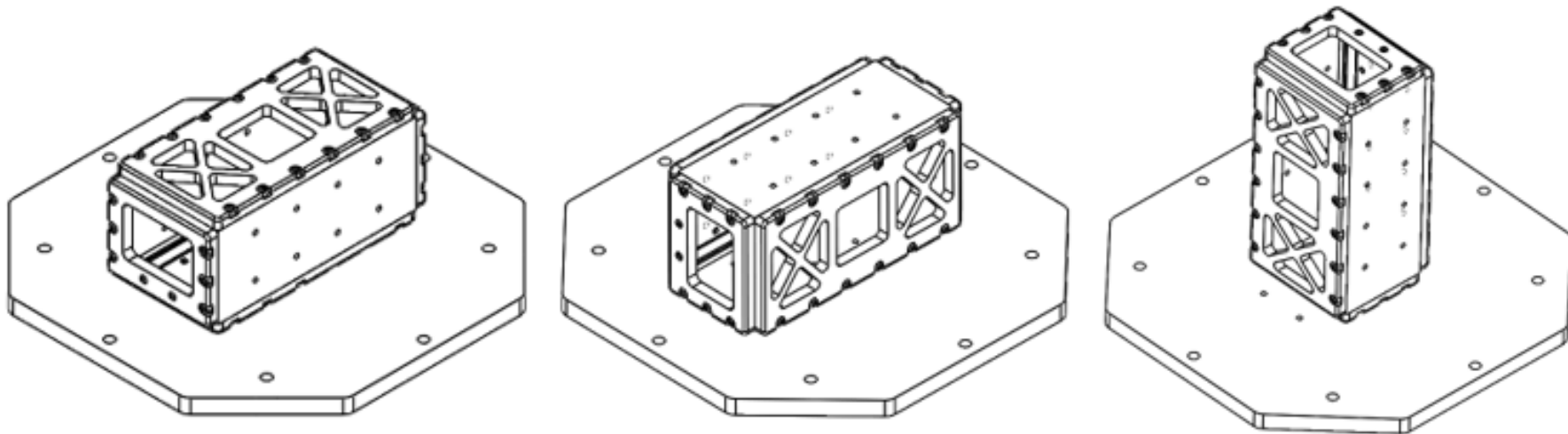

# Contact details

- Follow me on Twitter: @Spac3C4d3t
- LinkedIn: <https://www.linkedin.com/in/andrew-dunn-engineer/>
- Website: <https://wyrmenengineering.com/>
- Email: Andrew.dunn@wyrmenengineering.com

